

A6HP High Pressure Piston Pump

High Pressure Hydraulic Piston Pumps, 600-700 Bar Working Pressure,
High Pressure, High Rotational Speed, High Efficiency, Slim Design.
Cast Iron Pump Body, Re-Designed in 2025.

Designation;

02 Lt. 04 Lt. 06 Lt.

12 Lt. 15 Lt. 22 Lt.

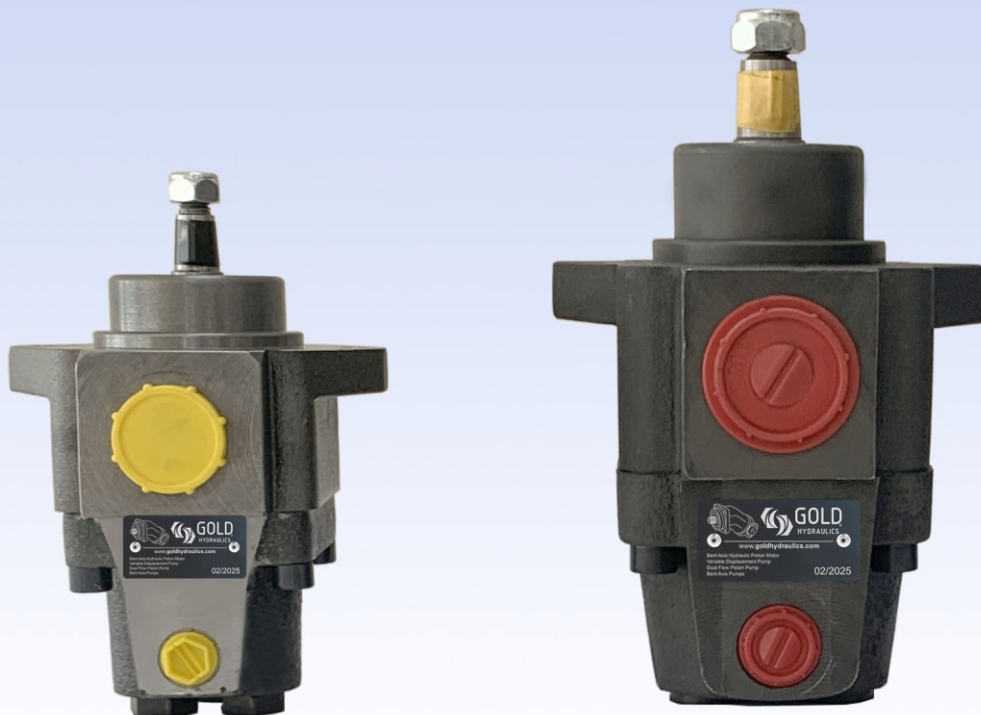

www.goldhydraulics.com

| | | 02 | 04 | 06 | 12 | 15 | 22 |
|---|-----------------|------------------------------|--------|--------|---------|---------|---------|
| Displacement | Litre | 1,56 | 2,70 | 4,40 | 7,80 | 10,50 | 14,73 |
| Theoretical oil flow l/min at pump speed | 1000 rpm | 1,56 | 2,70 | 4,40 | 7,80 | 10,50 | 14,73 |
| | 1500 rpm | 2,34 | 4,05 | 6,60 | 11,70 | 15,75 | 22,09 |
| Maximum Pump Speed | | | | | | | |
| - Continuous | rpm | 3000 | 3000 | 3000 | 2800 | 2800 | 2800 |
| - Limited | rpm | 3500 | 3500 | 3500 | 3000 | 3000 | 3000 |
| Max. Continuous Pressure | bar | 600 | 600 | 600 | 450 | 400 | 400 |
| Max. Peak Pressure | bar | 700 | 700 | 700 | 500 | 500 | 500 |
| Weight | | | | | | | |
| - Without inlet fitting | kg | 5,50 | 5,50 | 5,50 | 8,00 | 8,00 | 8,00 |
| - With inlet fitting | kg | 5,60 | 5,60 | 5,60 | 8,15 | 8,15 | 8,15 |
| Fluid | | Mineral Based Hydraulic Oils | | | | | |
| Inlet | | G 1" | G 1" | G 1" | G1 1/4" | G1 1/4" | G1 1/4" |
| Outlet | | G 3/8" | G 3/8" | G 3/8" | G 1/2" | G 1/2" | G 1/2" |

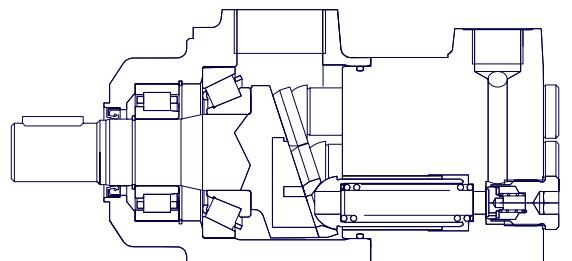
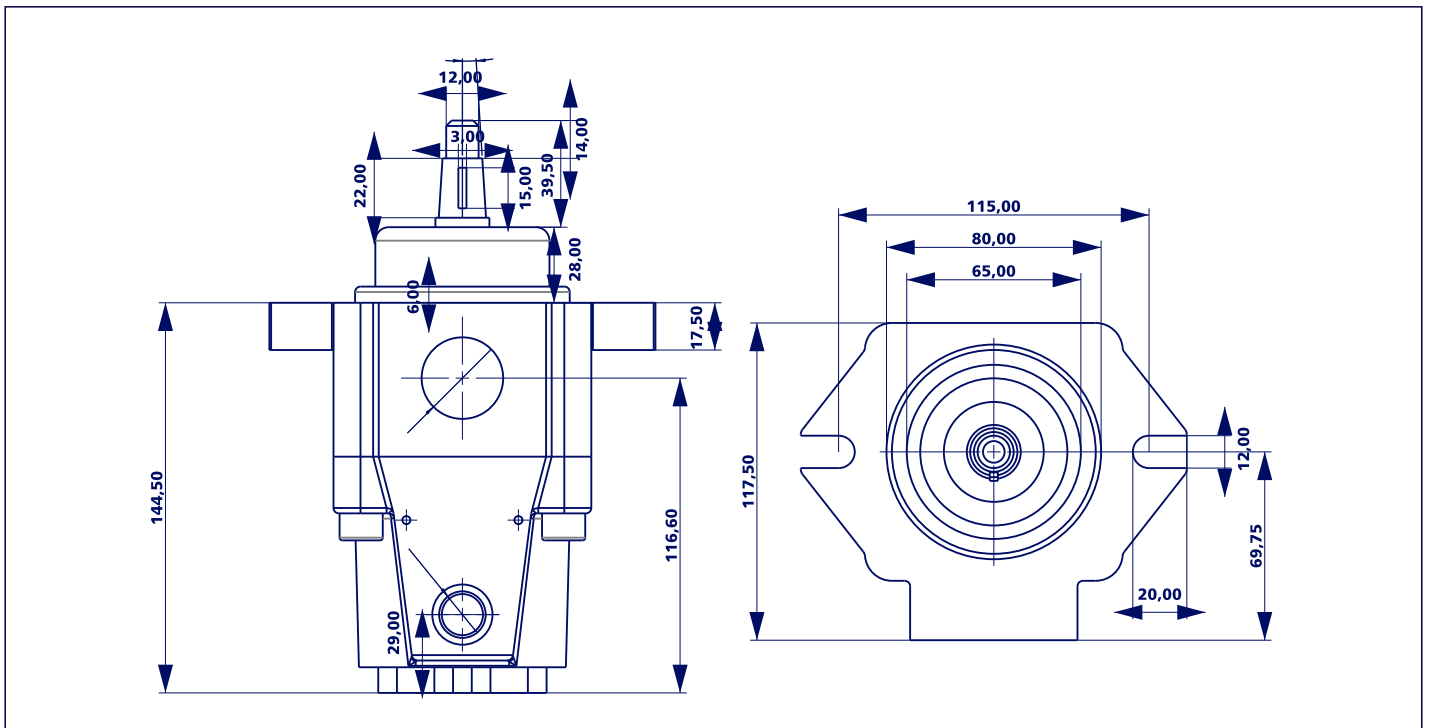

Pump Code Displacement (Litre)

A6HP

22

02 04 06 12 15 22

A6HP High Pressure Piston Pump, Fixed Displacement, 2 BOLT Mounting Flange

| Formulas | | | |
|-----------------------------------|------|---|---|
| Pump Output Flow | GPM | $GPM = (Speed \text{ (rpm)} \times disp. \text{ (cu. in.)}) / 231$ | $GPM = (n \times d) / 231$ |
| Pump Input Horsepower | HP | $HP = GPM \times Pressure \text{ (psi)} / 1714 \times Efficiency$ | $HP = (Q \times P) / 1714 \times E$ |
| Pump Efficiency | E | Overall Efficiency = Output HP / Input HP | $E_{overall} = HP_{out} / HP_{in} \times 100$ |
| | | Overall Efficiency = Volumetric Eff. \times Mechanical Eff. | $E_{overall} = EffVol. \times EffMech.$ |
| Pump Volumetric Efficiency | E | Volumetric Efficiency = Actual Flow Rate Output (GPM) / Theoretical Flow Rate Output (GPM) \times 100 | $EffVol. = Q_{act.} / Q_{theo.} \times 100$ |
| Pump Mechanical Efficiency | E | Mechanical Efficiency = Theoretical Torque to Drive / Actual Torque to Drive \times 100 | $EffMech = T_{theo.} / T_{act.} \times 100$ |
| Pump Displacement | CIPR | Displcmnt (In. ³ / rev.) = Flow Rate (GPM) \times 231 / Pump RPM | $CIPR = GPM \times 231 / RPM$ |
| Pump Torque | T | Torque = Horsepower \times 63025 / RPM | $T = 63025 \times HP / RPM$ |
| | | Torque = Pressure (PSIG) \times Pump Displacement (CIPR) / 2 π | $T = P \times CIPR / 6.28$ |

- Horsepower for driving a pump** : For every 1 hp of drive, the equivalent of 1 gpm @ 1500 psi can be produced.
- Horsepower for idling a pump** : To idle a pump when it is unloaded will require about 5% of it's full rated power
- Wattage for heating hydraulic oil** : Each watt will raise the temperature of 1 gallon of oil by 1° F. per hour.
- Flow velocity in hydraulic lines** : Pump suction lines 2 to 4 feet per second, pressure lines up to 500 psi - 10 to 15 ft./sec., pressure lines 500 to 3000 psi - 15 to 20 ft./sec.; all oil lines in air-over-oil systems; 4 ft./sec.

Efficiency Curves (1000 rpm)

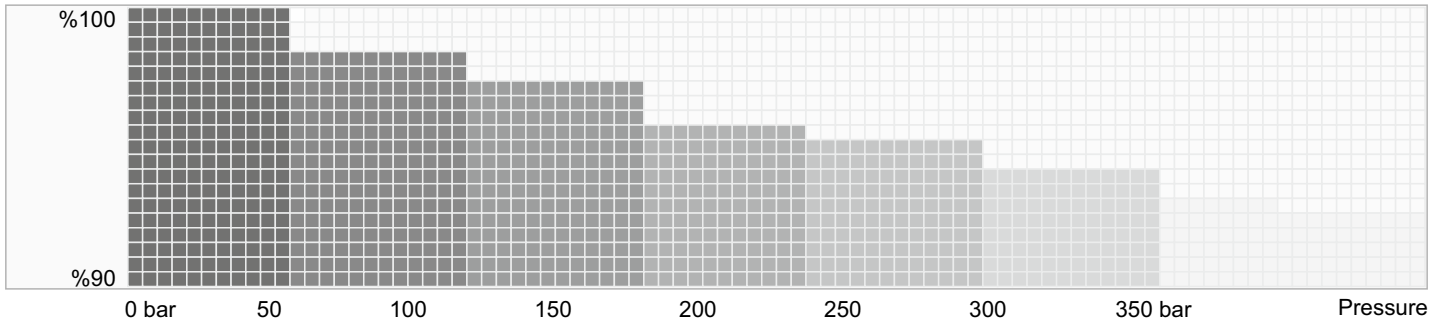

Flow

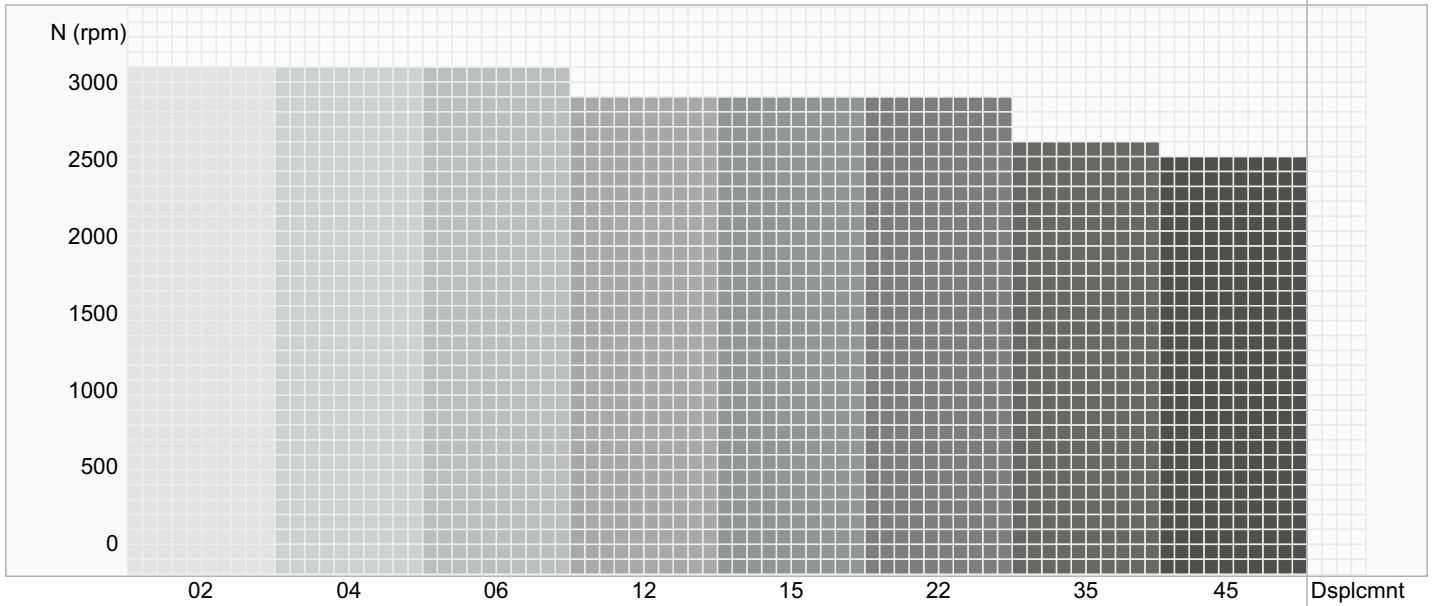

A6HP 02 Litre - High Pressure Piston Pump

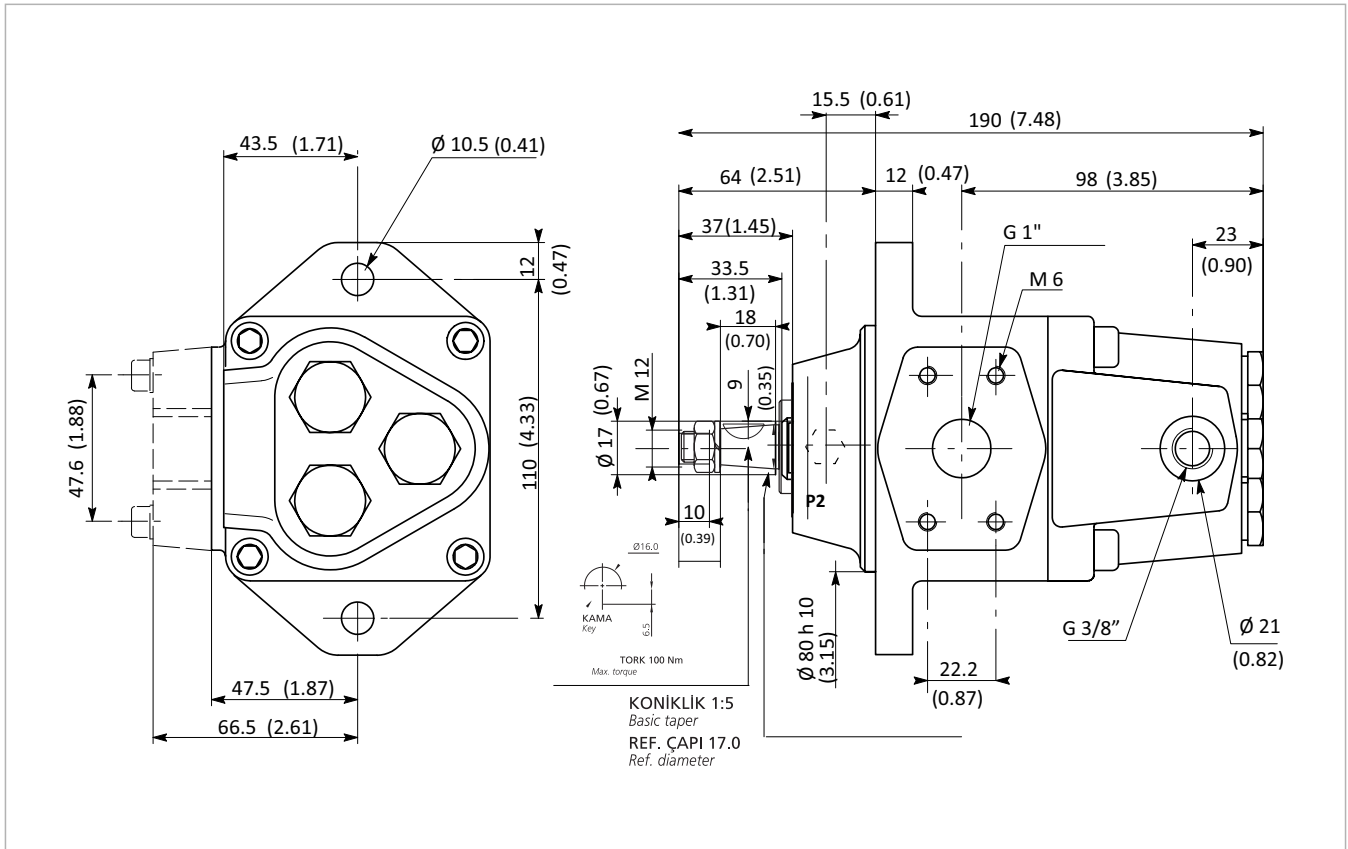

| | |
|-------------------------------------|---------------|
| x 1000 rpm | 1,56 Lt. |
| x 1500 rpm | 2,34 Lt. |
| Max. Continuous Pump Speed | 3000 rpm |
| Max. Limited Pump Speed | 3500 rpm |
| Max. Continuous Pressure | 600 bar |
| Max. Intermit. Peak Pressure | 700 bar |
| Weight without inlet fitting | 5,50 kg |
| Weight with inlet fitting | 5,60 kg |
| Fluid | Min.B.Hyd.Oil |
| Inlet | G 1" |
| Outlet | G 3/8" |

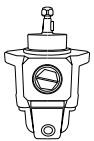

CW

Rotation :
Fixed-Clock Wise

A6HP 04 Litre - High Pressure Piston Pump

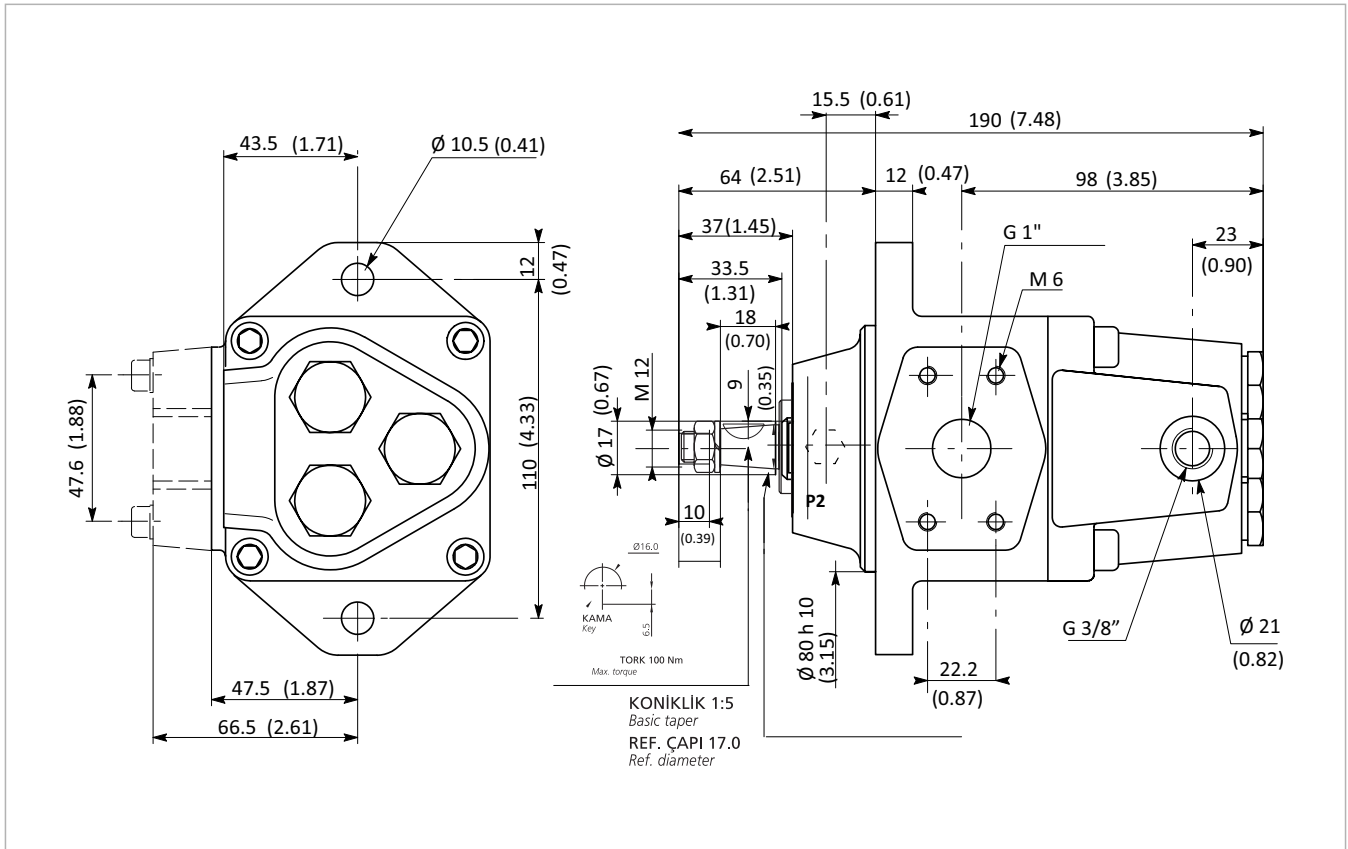

| | |
|-------------------------------------|---------------|
| x 1000 rpm | 2,70 Lt. |
| x 1500 rpm | 4,05 Lt. |
| Max. Continuous Pump Speed | 3000 rpm |
| Max. Limited Pump Speed | 3500 rpm |
| Max. Continuous Pressure | 600 bar |
| Max. Intermit. Peak Pressure | 700 bar |
| Weight without inlet fitting | 5,50 kg |
| Weight with inlet fitting | 5,60 kg |
| Fluid | Min.B.Hyd.Oil |
| Inlet | G 1" |
| Outlet | G 3/8" |

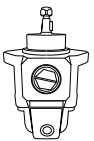

CW

Rotation :
Fixed-Clock Wise

A6HP 06 Lt. - High Pressure Piston Pump

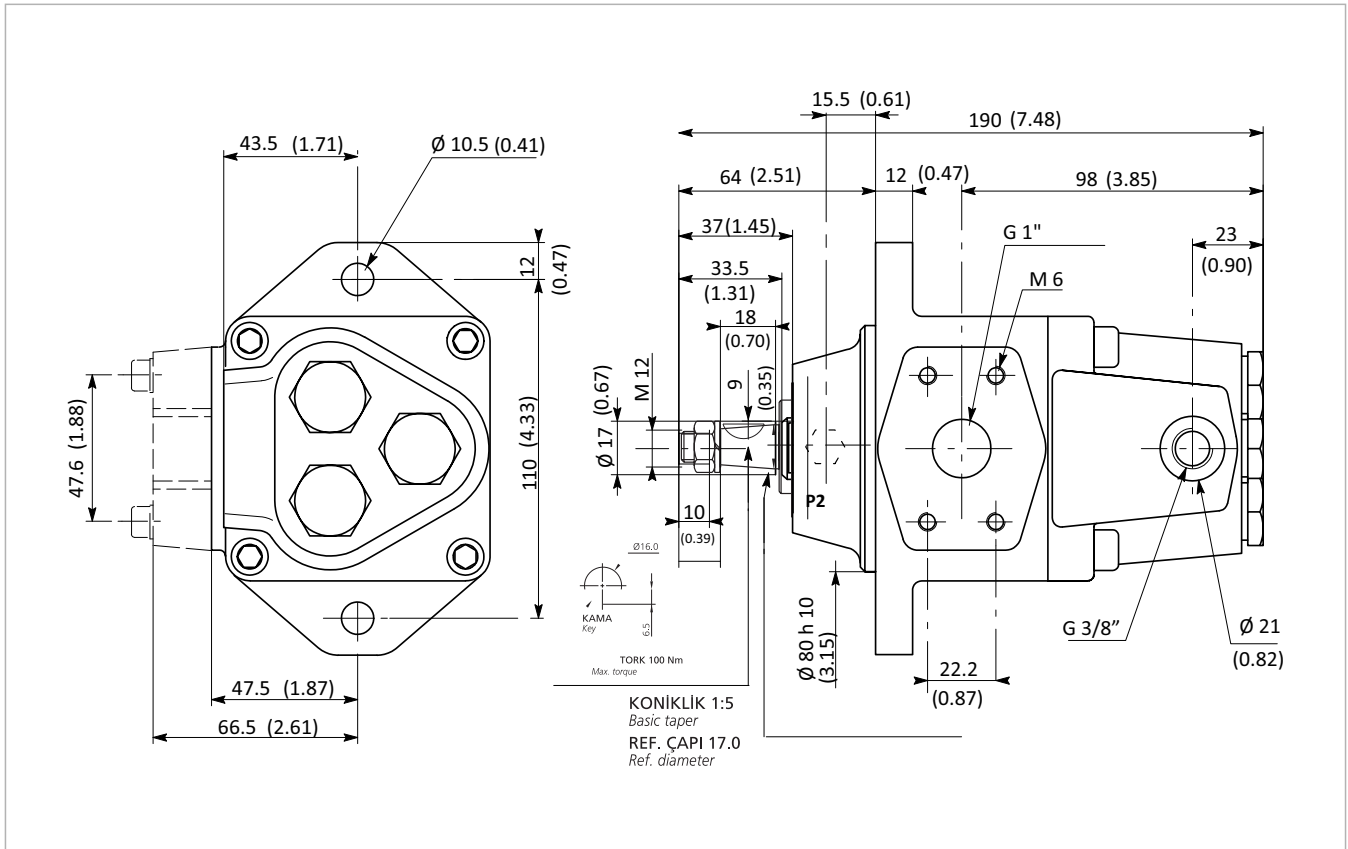

| | |
|-------------------------------------|---------------|
| x 1000 rpm | 4,40 Lt. |
| x 1500 rpm | 6,60 Lt. |
| Max. Continuous Pump Speed | 3000 rpm |
| Max. Limited Pump Speed | 3500 rpm |
| Max. Continuous Pressure | 600 bar |
| Max. Intermit. Peak Pressure | 700 bar |
| Weight without inlet fitting | 5,50 kg |
| Weight with inlet fitting | 5,60 kg |
| Fluid | Min.B.Hyd.Oil |
| Inlet | G 1" |
| Outlet | G 3/8" |

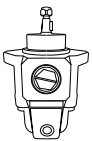

CW

Rotation :
Fixed-Clock Wise

A6HP 12 Lt. - High Pressure Piston Pump

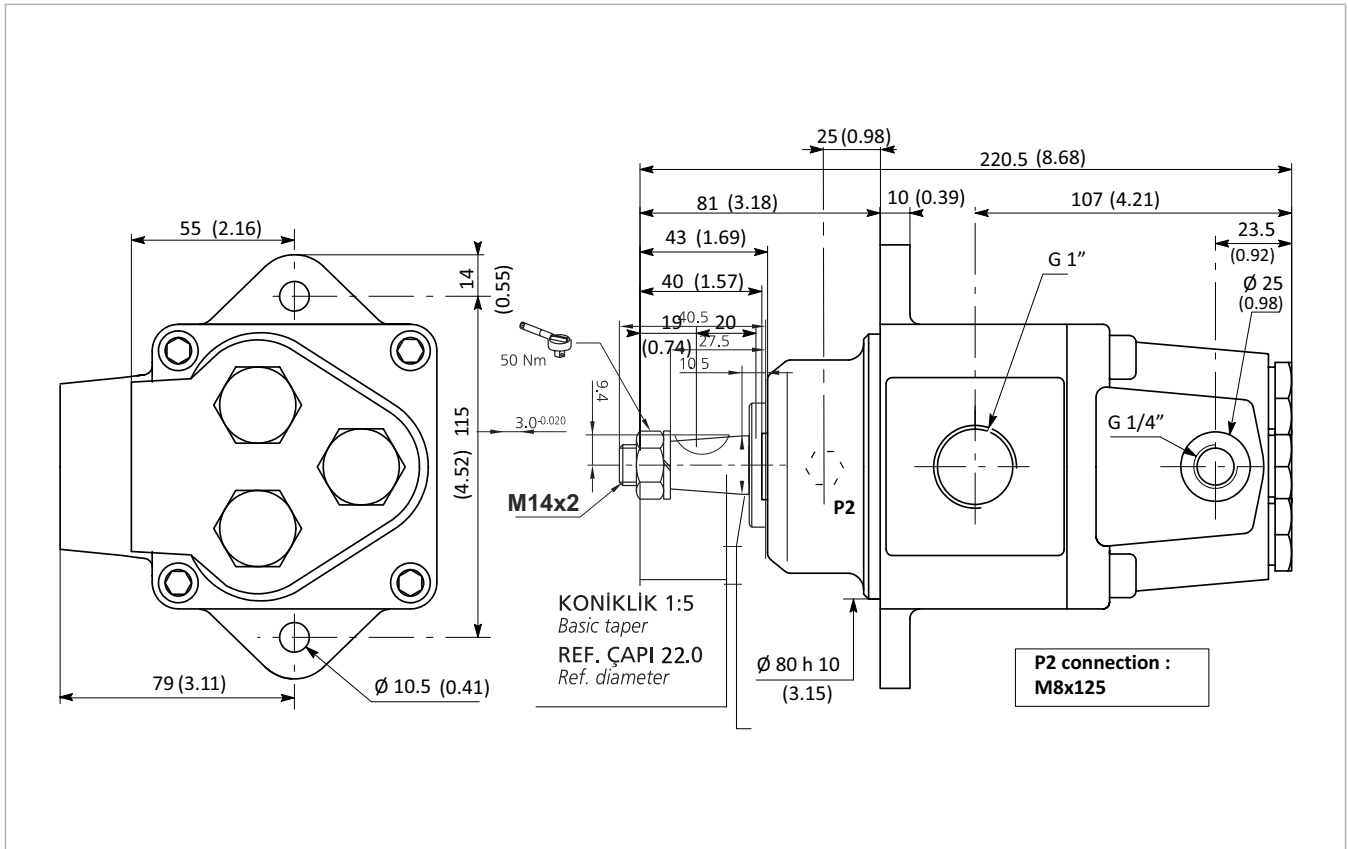

| | |
|-------------------------------------|---------------|
| x 1000 rpm | 7,80 Lt. |
| x 1500 rpm | 11,70 Lt. |
| Max. Continuous Pump Speed | 2800 rpm |
| Max. Limited Pump Speed | 3000 rpm |
| Max. Continuous Pressure | 450 bar |
| Max. Intermit. Peak Pressure | 500 bar |
| Weight without inlet fitting | 8,00 kg |
| Weight with inlet fitting | 8,15 kg |
| Fluid | Min.B.Hyd.Oil |
| Inlet | G1 1/4" |
| Outlet | G 1/2" |

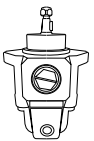

CW

Rotation :
Fixed-Clock Wise

High Pressure Piston Pumps designed for Industrial Area.

INSTALLATION

- Remove the protective covers off the inlet and output ports when connecting tubes or hosing.
- Rinse the tank and the tubes or hoses well to remove any possible contaminants.
- Before connecting up the pump inlet port, fill the tank and allow the oil to flow into a receptacle. This oil can be re-used after proper filtration.

OIL SUPPLY

Oil and supply line should be clean, and the supply line is airtight.

SUCTION LINE

Connect the suction line, tighten the suction connection bolts in diametric pairs.
Connect the pressure line.

REPAIR

We offers a comprehensive range of services for the repair of our Piston Pumps.
Repairs to the High Pressure Pump may only be performed by authorized, skilled and instructed personnel.
Only use original and pre-installed our spare parts from supplied to Manufacturer..

Tested and pre-installed pumps successful repair requiring only little time.

SPARE PARTS

The spare parts list and the pump order specific.
When ordering spare parts, quote the material and complete Ordering code number of the Piston Pump as well as the right numbers of the spare parts.

RISK OF DAMAGE!

Do not touch the drive shaft of the Piston Pump
Do not touch sensor, valves and fittings
Do not touch sealing surfaces.

DIMENSIONS & WEIGHTS

| | | 02 | 04 | 06 | 12 | 15 | 22 |
|-------------------------|-----------|------|------|------|------|------|------|
| - Without inlet fitting | kg | 5,50 | 5,50 | 5,50 | 8,00 | 8,00 | 8,00 |
| - With inlet fitting | kg | 5,60 | 5,60 | 5,60 | 8,15 | 8,15 | 8,15 |

Address all questions regarding spare parts to your responsible Our Service Partner or the technical service department of the manufacture's plant / factory for the Piston Pumps.

**AVAILABLE VIA E-MAIL ON REQUEST OR EACH PUMP IS
SUPPLIED VIA STARTING AND INSTALLATION DATASHEETS**

Complete Product Range

Bent Axis Piston Motors

- A9MD** (DIN) Bent Axis Motors
- A9MO** (ISO) Bent Axis Motors
- A9MS** (SAE) Bent Axis Motors
- A9ML** (SAE2) Bent Axis Motors
- A9MF** (Fixed Plugin) Bent Axis Motors
- A10M** (HYBRID) Bent Axis Motors
- A7GM** Hydraulic Gear Motors
- A7GMT** Tandem Hydraulic Gear Motors

Bent Axis Piston Pumps

- A8PA** (Aluminum) Bent Axis Pumps
- A8PD** (DIN) Bent Axis Pumps
- A8PO** (ISO) Bent Axis Pumps
- A8PS** (SAE) Bent Axis Pumps
- A8PF** (Fixed Plugin) Bent Axis Pumps
- A10** (HYBRID) Bent Axis Pumps
- A11** (ISO2) Bent Axis Pumps
- A11** (SAE2) Bent Axis Pumps

Variable Displacement Pumps

- A12V** Variable Displacement Piston Pumps

Dual Flow Piston Pumps

- A8PL** (DIN) Dual Flow Pumps

Axial Piston & Gear Pumps

- A4PP** Axial Hydraulic Piston Pumps
- A6HP** High Pressure Piston Pumps
- A7GP** Hydraulic Gear Pumps
- A7GPT** Tandem Hydraulic Gear Pumps

Valve (ByPass) (Flushing) (Cavitation)

- Circulation Valve
- ByPass Valve
- Anti-Cavitation Valve
- Flushing Valve
- LS Valve
- AntiShock Valve
- Speed Sensor

Hydraulic Spare Parts

- Suction Fittings
- Couplers
- Adapters
- Flanges
- Power Take Off
- Monoblock Valve
- Section Valve

Hydraulic Pumps, Motors

Bent Axis Hydraulic Piston Motors, Bent Axis Hydraulic Piston Pumps, Piston Pumps, Variable Displacement Piston Pumps, Variable Displacement Piston Motors, Axial Piston Pumps, High Pressure Piston Pumps, Gear Pumps, Gear Motors, Hydraulic Valve.

www.goldhydraulics.com

Address;

HYDROGOLD HİDROLİK PNM. MAK. SAN. TİC. LTD. ŞTİ.

Address; (Fabrika, İmalat)

Fevzicakmak Mah. Sıla Cad. Kobisan 3 San. Sit.

No: 73 / C Karatay – Konya, PO Code; 42050, Türkiye

Address; (Montaj, Sevkiyat)

Fevzicakmak Mah. Sıla Cad. Kobisan 3 San. Sit.

No: 71 / AD Karatay – Konya, PO Code; 42050, Türkiye

Phone; +90 551 148 26 88

mail@goldhydraulics.com